

# Linear Luminaire with LED EXLUX

## Series 6002/4

STAHL

E2



- The latest LED technology with a high luminous efficacy and a long service life
- Extremely high luminaire efficacy
- Luminous flux after 100,000 h still 90% of the starting luminous flux
- Optionally with DALI for controlling and monitoring the luminaire
- Optionally addressable for direct actuation of a common battery system

WebCode 6002D



The linear luminaire with Series 6002/4 LED is ideal for lighting surfaces at a mounting height of up to 10 m. It can also be used to illuminate equipment and objects, both inside and outside. The pole mounting sleeve accessory can be used to easily mount the luminaire on poles. Optionally, the luminaire can be equipped with addressable equipment. It can be used to control and monitor the luminaire for the common battery systems.

	ATEX / IECEx					
Zone	0	1	2	20	21	22
Installation in		•	•		•	•

Selection Table						
Design size			2			
Lamp wattage			22 W			
Luminous flux			2910 lm			
Luminaire efficacy			132 lm/W			
Drilled holes	Threaded plate	Screw connections	Stopping plug	Product Type	Art. No.	
3 x M20	2x SS430 stainless steel	Can be ordered as accessories	Can be ordered as accessories	6002/4128-0100-152-2220-22-8500	267067 ▲	
3 x M25	2x plastic	2 x M25 Ø 7 – 17 mm	2 x M25 x 1.5	6002/4128-0100-152-1110-11-8500	267058 ▲	
Design size			4			
Lamp wattage			42 W			
Luminous flux			5810 lm			
Luminaire efficacy			138 lm/W			
Drilled holes	Threaded plate	Screw connections	Stopping plug	Product Type	Art. No.	
3 x M20	2x SS430 stainless steel	Can be ordered as accessories	Can be ordered as accessories	6002/4148-0100-152-2220-22-8500	267077	
3 x M25	2x plastic	2 x M25 Ø 7 – 17 mm	2 x M25 x 1.5	6002/4148-0100-152-1110-11-8500	267074 ▲	
Design size			6			
Lamp wattage			50 W			
Luminous flux			6960 lm			
Luminaire efficacy			139 lm/W			
Drilled holes	Threaded plate	Screw connections	Stopping plug	Product Type	Art. No.	
3 x M20	2x SS430 stainless steel	Can be ordered as accessories	Can be ordered as accessories	6002/4168-0201-152-2220-22-8500	276338	
3 x M25	2x plastic	2 x M25 Ø 7 – 17 mm	2 x M25 x 1.5	6002/4168-0201-152-1110-11-8500	276335	

Screw connections and stopping plugs made from moulded material are included loose with the product (installation required). Threaded plate included.

The light fittings are supplied without mounting material.

Technical Data			
Variant	Size 2	Size 4	Size 6
<b>Explosion Protection</b>			
IECEX gas explosion protection	Ex db eb ib mb op is IIC T4 Gb	Ex db eb ib mb op is IIC T4 Gb	Ex db eb ib mb op is IIC T4 Gb
IECEX dust explosion protection	Ex tb op is IIIC T100 °C Db	Ex tb op is IIIC T100 °C Db	Ex tb op is IIIC T100 °C Db
ATEX gas explosion protection	Ⓜ II 2 G Ex db eb ib mb op is IIC T4 Gb	Ⓜ II 2 G Ex db eb ib mb op is IIC T4 Gb	Ⓜ II 2 G Ex db eb ib mb op is IIC T4 Gb
ATEX dust explosion protection	Ⓜ II 2 D Ex tb op is IIIC T100 °C Db	Ⓜ II 2 D Ex tb op is IIIC T100 °C Db	Ⓜ II 2 D Ex tb op is IIIC T100 °C Db
Certificates	ATEX (IBE), IECEx (IBE), India (PESO), Taiwan (ITRI)	ATEX (IBE), IECEx (IBE), India (PESO), Taiwan (ITRI)	
<b>Electrical Data</b>			
Rated operational voltage AC	100 – 240 V	100 – 240 V	110 – 240 V
Rated operational voltage DC	110 – 250 V	110 – 250 V	110 – 250 V
Frequency range	50 – 60 Hz	50 – 60 Hz	50 – 60 Hz
<b>Ambient Conditions</b>			
Ambient temperature	-40 °C ... +50 °C Note: Through wiring max. 3x16 A -40 °C ... +60 °C Note: Through wiring 2 max. 3x10 A	-40 °C ... +50 °C Note: Through wiring max. 3x16 A -40 °C ... +60 °C Note: Through wiring 2 max. 3x10 A	-20 °C ... +50 °C Note: Through wiring max. 3x16 A -20 °C ... +60 °C Note: Through wiring 2 max. 3x10 A
<b>Lighting Data</b>			
Number of lamps	1	1	1
Lamp	LED	LED	LED
Light colour	Neutral white	Neutral white	Neutral white
Light distribution	120°x120° with diffusing glass	120°x120° with diffusing glass	120°x120° with diffusing glass
Colour rendering	≥ 80	≥ 80	≥ 80
Colour temperature	5000 K	5000 K	5000 K
<b>Mechanical Data</b>			
Impact strength (IK code)	IK10 (IEC 62262)	IK10 (IEC 62262)	IK10 (IEC 62262)
Degree of protection IP (IEC 60598)	IP66/IP67	IP66/IP67	IP66
Enclosure colour	Light grey (RAL 7035)	Light grey (RAL 7035)	Light grey (RAL 7035)
Enclosure material	Polyester resin, Glass fibre reinforced	Polyester resin, Glass fibre reinforced	Polyester resin, Glass fibre reinforced
Diffuser	With diffuser	With diffuser	With diffuser
Sealing material	Silicone	Silicone	Silicone
Installed terminal strip	PE + N + L1 + L2 + L3	PE + N + L1 + L2 + L3	PE + N + L1 + L2 + L3
Connection terminals solid max.	6 mm <sup>2</sup>	6 mm <sup>2</sup>	6 mm <sup>2</sup>
Connection terminals finely-stranded max.	4 mm <sup>2</sup>	4 mm <sup>2</sup>	4 mm <sup>2</sup>
Type of connection cable	Solid Finely stranded	Solid Finely stranded	Finely stranded Solid
Notes	Connection terminals: Spring clamp terminal (2 free clamping units per pole)		
<b>Components</b>			
Ballast	6045/211-120-10	6045/211-120-10	6045/211-110-10
Through wiring	With 5 conductors 2.5 mm <sup>2</sup>	With 5 conductors 2.5 mm <sup>2</sup>	With 5 conductors 2.5 mm <sup>2</sup>
Material cable gland	Polyamide, black	Polyamide, black	Polyamide, black
Stopping plug material	Polyamide, black	Polyamide, black	Polyamide, black

## Light Distribution Curves – Subject to Alterations

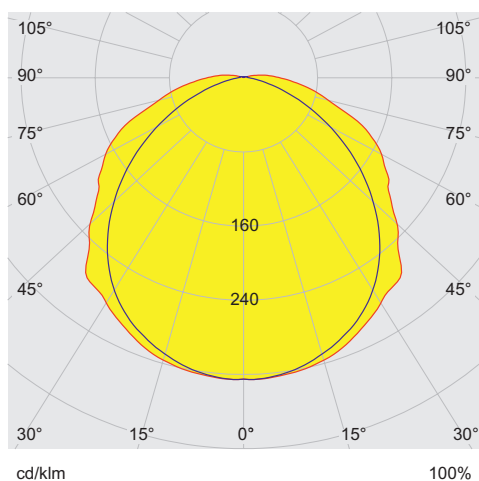

E2

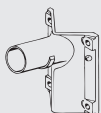
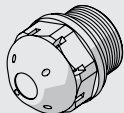
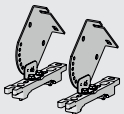
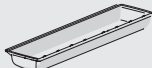
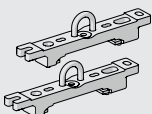

typical with diffusor

## Accessories

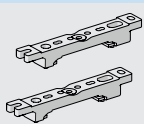
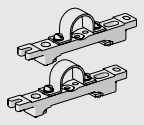
Figure	Description	Art. No.	Weight kg
<b>Bracket for wall mounting with tube</b>			
	for side entry lamp; with tube, length 400 mm, Ø 42 mm	108947 ▲	2.480
<b>Breather</b>			
	Thread: M25 x 1.5; 1 pc; for installation in lights; in moulded material; without counter nut	138573 ▲	0.010
	Thread: M25 x 1.5; 20 pc; for installation in lights; in moulded material; without counter nut	138576 ▲	0.200
<b>Ceiling and wall mounting bracket</b>			
	mounted on a mounting rail for a variable mounting distance; Material: stainless steel; Lamp can be swiveled in steps of 15°; 1 pair	222827 ▲	1.200
<b>Cover</b>			
	for luminaire size 4 (resistant to aromatic substances)	256535	1.167
	for luminaire size 6 (resistant to aromatic substances)	256536	1.473
	for luminaire size 2 (resistant to aromatic substances)	256534	0.679
	for luminaire size 4 (diffuse), the visibility of the indicator LED may be restricted when used on a single supplied emergency luminaire	276670	-
<b>Mounting bracket</b>			
	mounting clamp mounted on a mounting rail for a variable mounting distance; 1 pair	222456 ▲	0.400

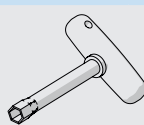
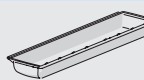
Accessories			
Figure	Description	Art. No.	Weight kg
Bracket for wall mounting with tube			
Mounting rail			
	for a variable mounting distance; 1 pair	222826 ▲	0.350
Pipe clamp			
	R 1 1/2"; with mounting rail for a variable mounting distance; Material: stainless steel; 1 pair	222459 ▲	0.800
	R 1 1/4"; with mounting rail for a variable mounting distance; Material: stainless steel; 1 pair	222458 ▲	0.700
	R 2"; with mounting rail for a variable mounting distance; Material: stainless steel; 1 pair	222460 ▲	0.750
Pole mounting sleeve			
	for the subsequent mounting on lights size 2 and size 4, completely with assembly parts (for pipe diameter 42 mm)	227512	3.200
Ring bolt			
	M8, direct mounting in insert nuts; 1 pair	115736 ▲	0.115
Socket key			
	M8 / wrench size 13; to open/close the central locking	222430 ▲	0.210
Cover			
	for luminaire size 2 (diffuse), the visibility of the indicator LED may be restricted when used on a single supplied emergency luminaire	276669	-

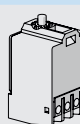
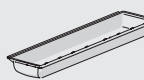
Spare Parts			
Figure	Description	Art. No.	Weight kg
Contact element			
	8080/1-3-L 2 NC contact element	132527	0.026
Cover			
	for luminaire size 4	222428	1.149
	for luminaire size 6	222429	1.450
	for luminaire size 2	222427	0.639

Dimensional Drawings (All Dimensions in mm [inches]) – Subject to Alterations

E2

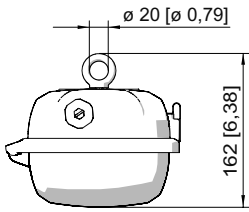

Ring bolt fitted in insert nut of the luminaire

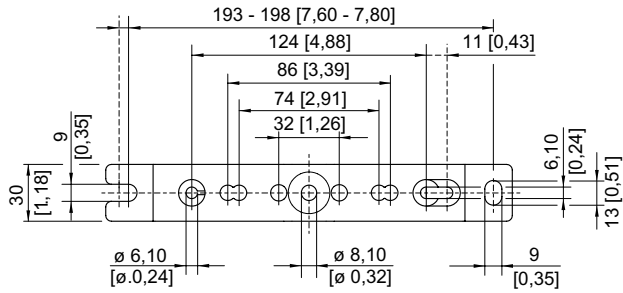
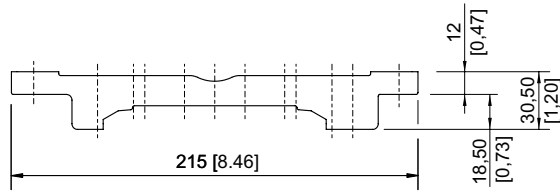

Mounting rail

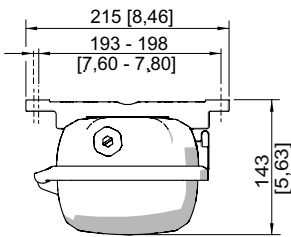

Mounting rail

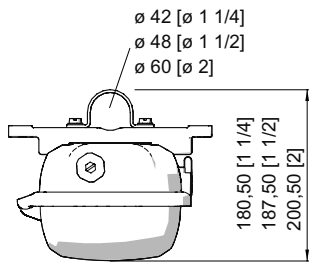

Pipe clamp fitted in mounting rail

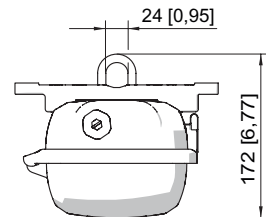

Mounting bracket fitted in mounting rail

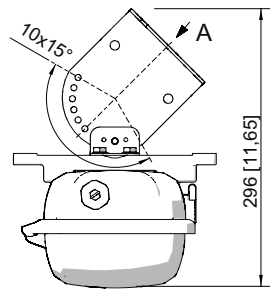

A

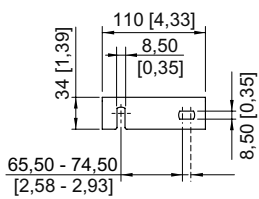

Wall mounting bracket fitted in mounting rail

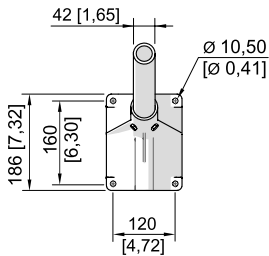

Bracket for wall mounting with pipe section

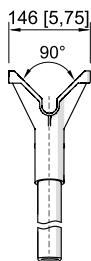
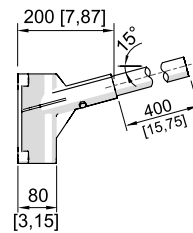

E2

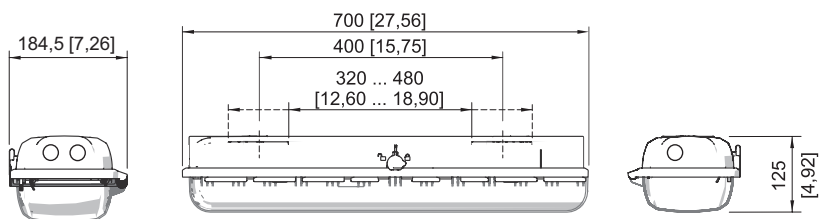

Size 2

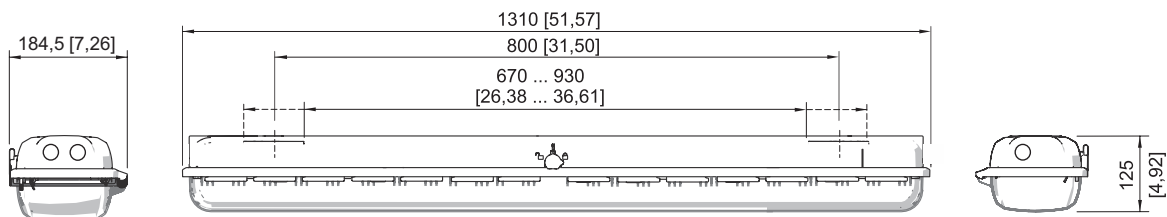

Size 4

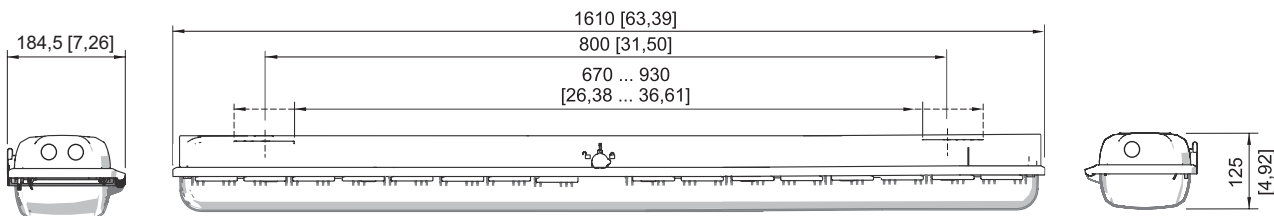

Size 6

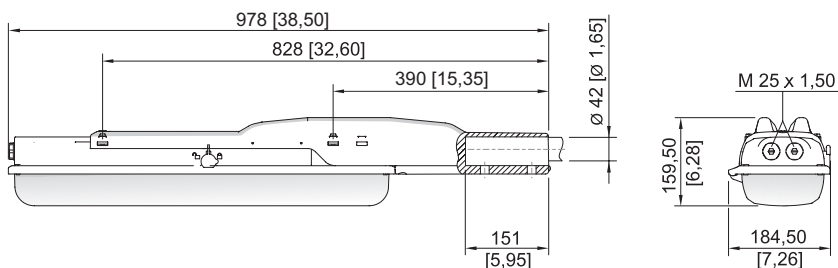

Size 2

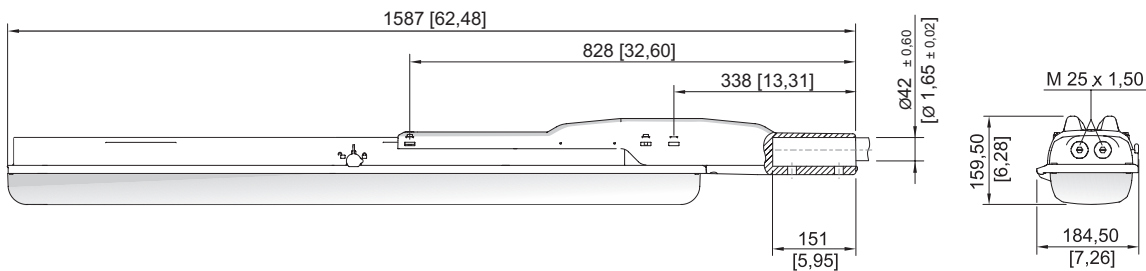

Size 4

**Inrush current**

$I_{peak} = 51 \text{ A}$ ;  $\Delta t = 127 \mu\text{s}$

Maximum number of luminaires per miniature circuit breaker:

Type	10 A	16 A	20 A	25 A
B	12	19	24	31

# Linear Luminaire with LED EXLUX

Series 6002/4



C	20	33	41	51
K	41	66	82	103

E2

typical value for 1-pole miniature circuit breaker at +25 °C and nominal voltage 230 V AC; the exact number depends on the miniature circuit breaker used